



N.B. For the correct choice of the gearmotor, please refer to the tables on page 118. Refer to AM series page 12 for motor revs under load. These geared motors require a running-in period, therefore, during the first 30 working hours, the resulting torque will be lower than the values given. On request, motor can be supplied with electromagnetic brake at 230 Vac, marked with letter KA (PCEKA), or at 24 Vdc marked with letter KB (PCEKB), see specifications on page 120.

N.B. Para una selección correcta del motorreductor se aconseja ajustarse a las tablas presentadas en la página 118. Para las revoluciones motor bajo carga hágase referencia a la serie AM en la pág. 12. Estos motorreductores necesitan un cierto rodaje. Por lo tanto, en las primeras 30 horas de funcionamiento, se notará un par menor que los datos presentados. A petición es posible suministrar el motor con freno electromagnético alimentado con 230 Vca, que se distingue por la letra KA (PCEKA), ó 24 Vdc, que se distingue por las letras KB (PCEKB), ver características en la pág. 120.

WORM SCREW GEAR MOTOR WITH PLANETARY REDUCTION GEAR

MOTOR: Asynchronous single or three phase with 2 or 4 poles, totally enclosed with external ventilation. Thermal safety cutout on single phase models. Class F windings. IP65 protection according to CEI EN 60529.

GEAR UNIT: With die-cast aluminum worm housing reduction and steel planetary housing reduction with three internal planetary gears, ratio $i = 4.75$. Worm Center Distance 1.260 inches. CARO bronze gear ring with 120-160 HB hardness. Hardened steel worm with ground threads rotating on ball and roller bearings. Lubricated with synthetic oil. High temperature oil seals. 9 reduction gear ratios (i) are available from 33.25 to 475. Maximum rated torque 797.0 in-lbs. Versions B3 and B5. B5/S Left Version – B5/D Right Version.

MOTORREDUCTOR DE TORNILLOS SIN FIN CON REDUCTOR EPICICLOIDAL

MOTOR: *asíncrono monofásico o trifásico de 2 ó 4 polos, en forma cerrada con ventilación externa. Protector térmico de seguridad en el tipo monofásico. Aislamiento clase F. Protección IP 65 según normas CEI EN 60529.*

REDUCTOR: *con carcasa de aluminio inyectado a presión en la primera etapa de reducción con tornillo sin fin, y de acero en la segunda etapa de reducción de tipo epicicloidal con tres satélites internos. Corona de bronce CARO, dureza 120-160 HB. Tornillo de acero templado con filete rectificado que gira sobre cojinetes de bolas. Lubricación con aceite especial de larga duración. Retenes de estanqueidad de goma especial para altas temperaturas. Las relaciones de reducción disponibles (i) son 9, de 33.25 a 475. Par nominal 797 in-lbs. Versión B3 ó B5. B5/S izquierdo - B5/D derecho.*



PCE

| Type | Ratio | Delivered power | Input r.p.m. no-load | Output r.p.m. no-load | Rated torque | Voltage | Current | Capacitor |
|------------|----------|--------------------|--------------------------------|-------------------------------|--------------|-------------|------------|-------------|
| Tipo | Relación | Potencia entregada | Revoluciones entrada sin carga | Revoluciones salida sin carga | Par nominal | Tensión | Intensidad | Condensador |
| | i | HP | rpm | rpm | in-lbs | Vac - 60 Hz | A | µF |
| PCE 240M3 | 33.25 | 1/5 | 3360 | 101 | 132 | 115 1Ø | 2.47 | 32 |
| PCE 330M4 | 33.25 | 1/3 | 3360 | 101 | 183 | 115 1Ø | 3.60 | 40 |
| PCE165M3 | 33.25 | 1/14 | 1680 | 50 | 92 | 115 1Ø | 1.28 | 16 |
| PCE 220M4 | 33.25 | 1/9 | 1680 | 50 | 132 | 115 1Ø | 1.68 | 20 |
| PCE 440M3T | 33.25 | 1/4 | 3360 | 101 | 167 | 230 3Ø | 1.08 | - |
| PCE 530M4T | 33.25 | 1/2 | 3360 | 101 | 248 | 230 3Ø | 1.68 | - |
| PCE 230M3T | 33.25 | 1/10 | 1680 | 50 | 132 | 230 3Ø | 0.70 | - |
| PCE 310M4T | 33.25 | 1/7 | 1680 | 50 | 183 | 230 3Ø | 0.93 | - |
| PCE 240M3 | 47.5 | 1/5 | 3360 | 71 | 180 | 115 1Ø | 2.47 | 32 |
| PCE 330M4 | 47.5 | 1/3 | 3360 | 71 | 251 | 115 1Ø | 3.60 | 40 |
| PCE165M3 | 47.5 | 1/14 | 1680 | 35 | 124 | 115 1Ø | 1.28 | 16 |
| PCE 220M4 | 47.5 | 1/9 | 1680 | 35 | 180 | 115 1Ø | 1.68 | 20 |
| PCE 440M3T | 47.5 | 1/4 | 3360 | 71 | 232 | 230 3Ø | 1.08 | - |
| PCE 530M4T | 47.5 | 1/2 | 3360 | 71 | 340 | 230 3Ø | 1.68 | - |
| PCE 230M3T | 47.5 | 1/10 | 1680 | 35 | 176 | 230 3Ø | 0.70 | - |
| PCE 310M4T | 47.5 | 1/7 | 1680 | 35 | 251 | 230 3Ø | 0.93 | - |
| PCE 240M3 | 95 | 1/5 | 3360 | 36 | 319 | 115 1Ø | 2.47 | 32 |
| PCE 330M4 | 95 | 1/3 | 3360 | 36 | 455 | 115 1Ø | 3.60 | 40 |
| PCE165M3 | 95 | 1/14 | 1680 | 18 | 224 | 115 1Ø | 1.28 | 16 |
| PCE 220M4 | 95 | 1/9 | 1680 | 18 | 319 | 115 1Ø | 1.68 | 20 |
| PCE 440M3T | 95 | 1/4 | 3360 | 36 | 415 | 230 3Ø | 1.08 | - |
| PCE 530M4T | 95 | 1/2 | 3360 | 36 | 614 | 230 3Ø | 1.68 | - |
| PCE 230M3T | 95 | 1/10 | 1680 | 18 | 319 | 230 3Ø | 0.70 | - |
| PCE 310M4T | 95 | 1/7 | 1680 | 18 | 447 | 230 3Ø | 0.93 | - |
| PCE 240M3 | 142.5 | 1/5 | 3360 | 24 | 439 | 115 1Ø | 2.47 | 32 |
| PCE 330M4 | 142.5 | 1/3 | 3360 | 24 | 619 | 115 1Ø | 3.60 | 40 |
| PCE165M3 | 142.5 | 1/14 | 1680 | 12 | 307 | 115 1Ø | 1.28 | 16 |
| PCE 220M4 | 142.5 | 1/9 | 1680 | 12 | 439 | 115 1Ø | 1.68 | 20 |
| PCE 440M3T | 142.5 | 1/4 | 3360 | 24 | 566 | 230 3Ø | 1.08 | - |
| PCE 530M4T | 142.5 | 1/2 | 3360 | 24 | *797 | 230 3Ø | 1.68 | - |
| PCE 230M3T | 142.5 | 1/10 | 1680 | 12 | 434 | 230 3Ø | 0.70 | - |
| PCE 310M4T | 142.5 | 1/7 | 1680 | 12 | 611 | 230 3Ø | 0.93 | - |
| PCE 240M3 | 190 | 1/5 | 3360 | 18 | 550 | 115 1Ø | 2.47 | 32 |
| PCE330M4 | 190 | 1/3 | 3360 | 18 | 782 | 115 1Ø | 3.60 | 40 |
| PCE165M3 | 190 | 1/14 | 1680 | 9 | 387 | 115 1Ø | 1.28 | 16 |
| PCE 220M4 | 190 | 1/9 | 1680 | 9 | 550 | 115 1Ø | 1.68 | 20 |
| PCE 440M3T | 190 | 1/4 | 3360 | 18 | 714 | 230 3Ø | 1.08 | - |
| PCE 530M4T | 190 | 1/2 | 3360 | 18 | *797 | 230 3Ø | 1.68 | - |
| PCE 230M3T | 190 | 1/10 | 1680 | 9 | 550 | 230 3Ø | 0.70 | - |
| PCE 310M4T | 190 | 1/7 | 1680 | 9 | 774 | 230 3Ø | 0.93 | - |



| Type | Ratio | Delivered power | Input r.p.m. no-load | Output r.p.m. no-load | Rated torque | Voltage | Current | Capacitor |
|------------|----------|--------------------|--------------------------------|-------------------------------|--------------|-------------|------------|-------------|
| Tipo | Relación | Potencia entregada | Revoluciones entrada sin carga | Revoluciones salida sin carga | Par nominal | Tensión | Intensidad | Condensador |
| | i | HP | rpm | rpm | in-lbs | Vac - 60 Hz | A | µF |
| PCE 240M3 | 237.5 | 1/5 | 3360 | 14.4 | 671 | 115 1Ø | 2.47 | 32 |
| PCE165M3 | 237.5 | 1/14 | 1860 | 7.2 | 467 | 115 1Ø | 1.28 | 16 |
| PCE 440M3T | 237.5 | 1/4 | 3360 | 14.4 | *797 | 230 3Ø | 1.08 | - |
| PCE 230M3T | 237.5 | 1/10 | 1860 | 7.2 | 667 | 230 3Ø | 0.70 | - |
| PCE 240M3 | 285 | 1/5 | 3360 | 12 | *717 | 115 1Ø | 2.47 | 32 |
| PCE165M3 | 285 | 1/14 | 1860 | 6 | 558 | 115 1Ø | 1.28 | 16 |
| PCE 440M3T | 285 | 1/4 | 3360 | 12 | *717 | 230 3Ø | 1.08 | - |
| PCE 230M3T | 285 | 1/10 | 1860 | 6 | *717 | 230 3Ø | 0.70 | - |
| PCE 240M3 | 332.5 | 1/5 | 3360 | 10 | *681 | 115 1Ø | 2.47 | 32 |
| PCE165M3 | 332.5 | 1/14 | 1860 | 5 | 575 | 115 1Ø | 1.28 | 16 |
| PCE 440M3T | 332.5 | 1/4 | 3360 | 10 | *681 | 230 3Ø | 1.08 | - |
| PCE 230M3T | 332.5 | 1/10 | 1860 | 5 | *681 | 230 3Ø | 0.70 | - |
| PCE 240M3 | 475 | 1/5 | 3360 | 7.2 | *522 | 115 1Ø | 2.47 | 32 |
| PCE165M3 | 475 | 1/14 | 1860 | 3.6 | *522 | 115 1Ø | 1.28 | 16 |
| PCE 440M3T | 475 | 1/4 | 3360 | 7.2 | *522 | 230 3Ø | 1.08 | - |
| PCE 230M3T | 475 | 1/10 | 1860 | 3.6 | *522 | 230 3Ø | 0.70 | - |

(*) - Under no circumstances should the torque values marked with an asterisk be exceeded. With the higher gear ratios the motor power is considerably higher than the capacity of the gear unit.

(*) - Los valores referentes al par marcados con el asterisco, no se deben en absoluto superar, ya que, con las altas relaciones, la potencia del motor es notablemente mayor que la capacidad del reductor.

Also available in 230 Vac single phase input.
 Also available in 460 Vac three phase input.
 Note - 230 Vac three phase suitable at 208 Vac.

Disponible también con entrada monofásica de 230 Vca.
 Disponible también con entrada trifásica de 460 Vca.
 Nota - 230 Vca trifásica adecuada para 208 Vca.



PCE

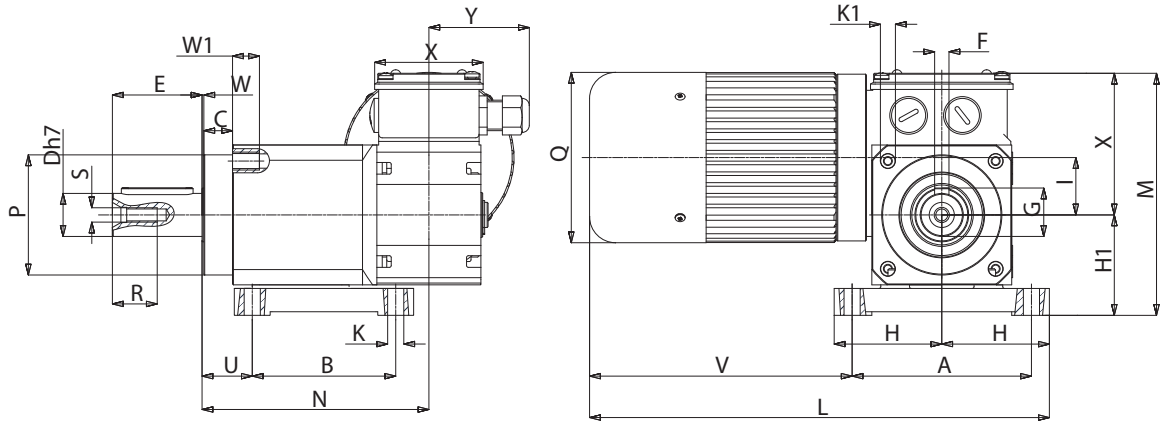

B3/S

| Type Tipo | A | B | C | D | E | F | G | H | H1 | K | K1 | I | L | M |
|-----------|-------|-------|-------|-------|-------|-------|-------|-------|-------|-------|-----|-------|--------|-------|
| PCE...M3 | 3.937 | 3.149 | 0.630 | 0.945 | 1.968 | 0.315 | 1.063 | 2.362 | 2.205 | 0.354 | M10 | 1.259 | 10.118 | 5.354 |
| PCE...M4 | 3.937 | 3.149 | 0.630 | 0.945 | 1.968 | 0.315 | 1.063 | 2.362 | 2.205 | 0.354 | M10 | 1.259 | 11.300 | 5.354 |

| Type Tipo | N | P | Q | R | S | T | U | V | W | W1 | X | Y | Weight Peso lbs |
|-----------|-------|-------|-------|-------|----|-------|-------|-------|-------|-------|-------|-------|-----------------------|
| PCE...M3 | 5.000 | 2.638 | 3.740 | 0.866 | M8 | 0.591 | 1.102 | 5.787 | 0.039 | 0.590 | 3.149 | 2.205 | 15.96 |
| PCE...M4 | 5.000 | 2.638 | 3.740 | 0.866 | M8 | 0.591 | 1.102 | 6.968 | 0.039 | 0.590 | 3.149 | 2.205 | 18.39 |

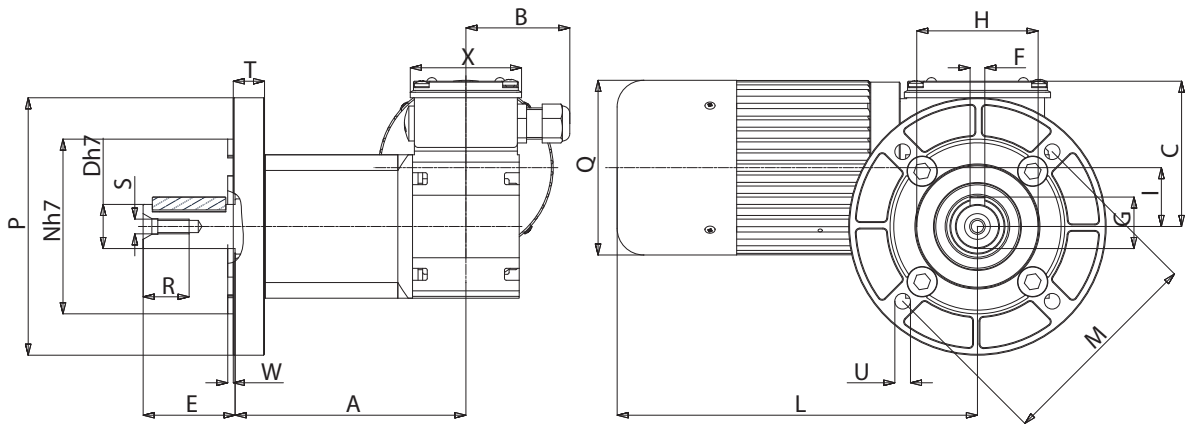

B5/S

| Type Tipo | A | B | C | D | E | F | G | H | I | L | M |
|-----------|-------|-------|-------|-------|-------|-------|-------|-------|-------|-------|-------|
| PCE...M3 | 5.000 | 2.205 | 3.149 | 0.945 | 1.968 | 0.315 | 1.063 | 2.638 | 1.259 | 7.756 | 4.528 |
| PCE...M4 | 5.000 | 2.205 | 3.149 | 0.945 | 1.968 | 0.315 | 1.063 | 2.638 | 1.259 | 8.937 | 4.528 |

| Type Tipo | N | P | Q | R | S | T | U | W | X | Weight Peso lbs |
|-----------|-------|-------|-------|-------|----|-------|-------|-------|-------|-----------------------|
| PCE...M3 | 3.740 | 5.512 | 3.740 | 0.866 | M8 | 0.669 | 0.354 | 0.118 | 2.362 | 15.43 |
| PCE...M4 | 3.740 | 5.512 | 3.740 | 0.866 | M8 | 0.669 | 0.354 | 0.118 | 2.362 | 17.42 |

For the self-braking version, add the letter KA or KB to the type designation. Dimensions L, V, increase by 0.984 in.

En la versión freno, añadir las letras KA ó KB a la sigla del tipo. Las cotas L, V aumentan de 0.984 in.